

Sink Phantom Base Gun Metal

Recommended for 12 mm thickness

Kitchen Sinks

Code: 5554 346



DETAILS

| | |
|-------------------|--|
| Material | AISI 304 stainless steel |
| Texture | Foster brushed |
| Finish | PVD |
| Coloring | Gun Metal |
| Dimensions | 430 x 430 mm |
| Number of bowls | 1 bowl |
| Bowl dimension | 406 x 406 mm |
| Built-in hole | View technical data sheet |
| Standard fittings | Drain, Foster overflow and universal corrugated pipe (for installing different overflows), Boxed packing |

Waste fitting

3,5" drain

Notes:

For 12 mm thick sheets

FEATURES

Gun Metal

The Gun Metal finish is obtained by treating steel with a physical process called PVD (Physical Vacuum Deposition) which deposits particles of noble metals on the surface. The result is a unique and refined aesthetic effect, and an improvement of the mechanical properties of the steel which is more resistant to impact and scratches.

PHANTOM BASE - 12 mm

The Phantom BASE sink's bottoms are specifically engineered to be coupled with sinks made out of slabs. The perimetric trough makes for a simple and perfect installation. This version of Phantom BASE is meant for slabs of 12mm thickness.

PHANTOM BASE WITHOUT WELDING

The steel bottom Phantom BASE solves the problem of water draining of slab sinks, because the slope built into the moulded bottom ensures perfect draining. The radius and sloped profile of Phantom BASE guarantee great practicality and hygiene in everyday cleaning.

High thickness

1mm thick steel. A significant thickness, which guarantees the maximum sturdiness and durability.

Perimetral overflow

The overflow is always a security on the Foster sinks that prevents the overflow of water in case of oversights. The perimeter drain solution improves aesthetics thanks to its square and essential shape.

TECHNICAL DATA

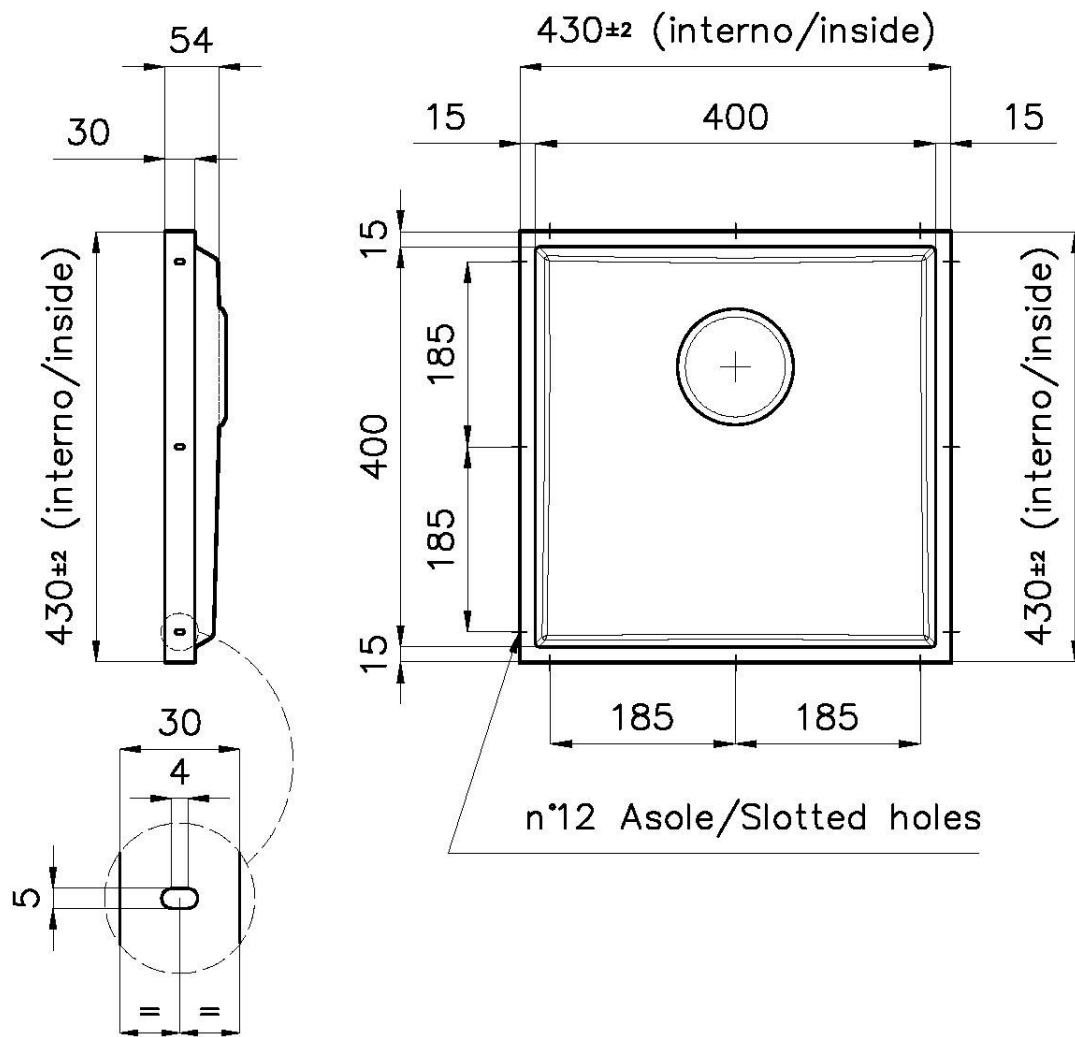

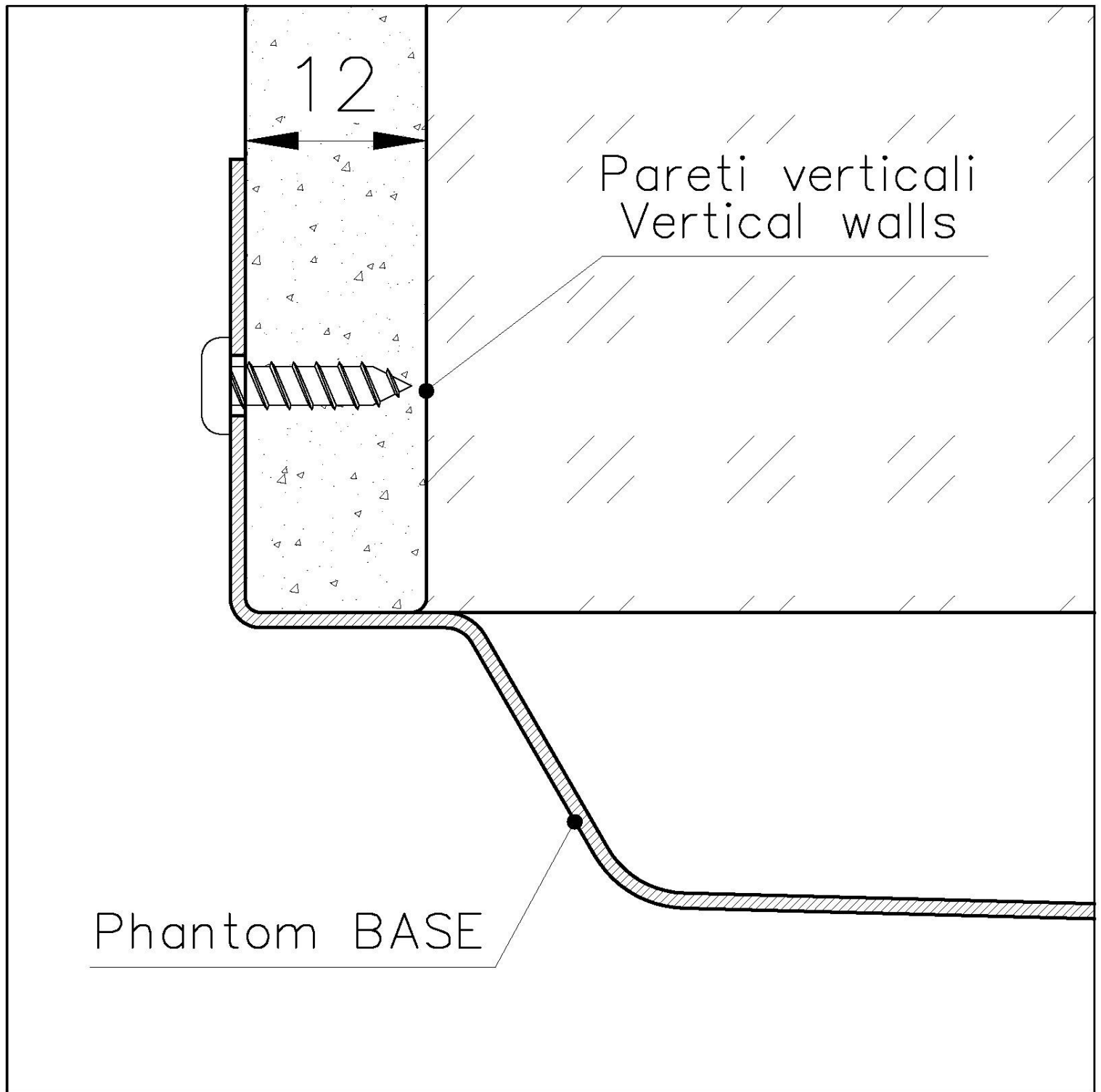

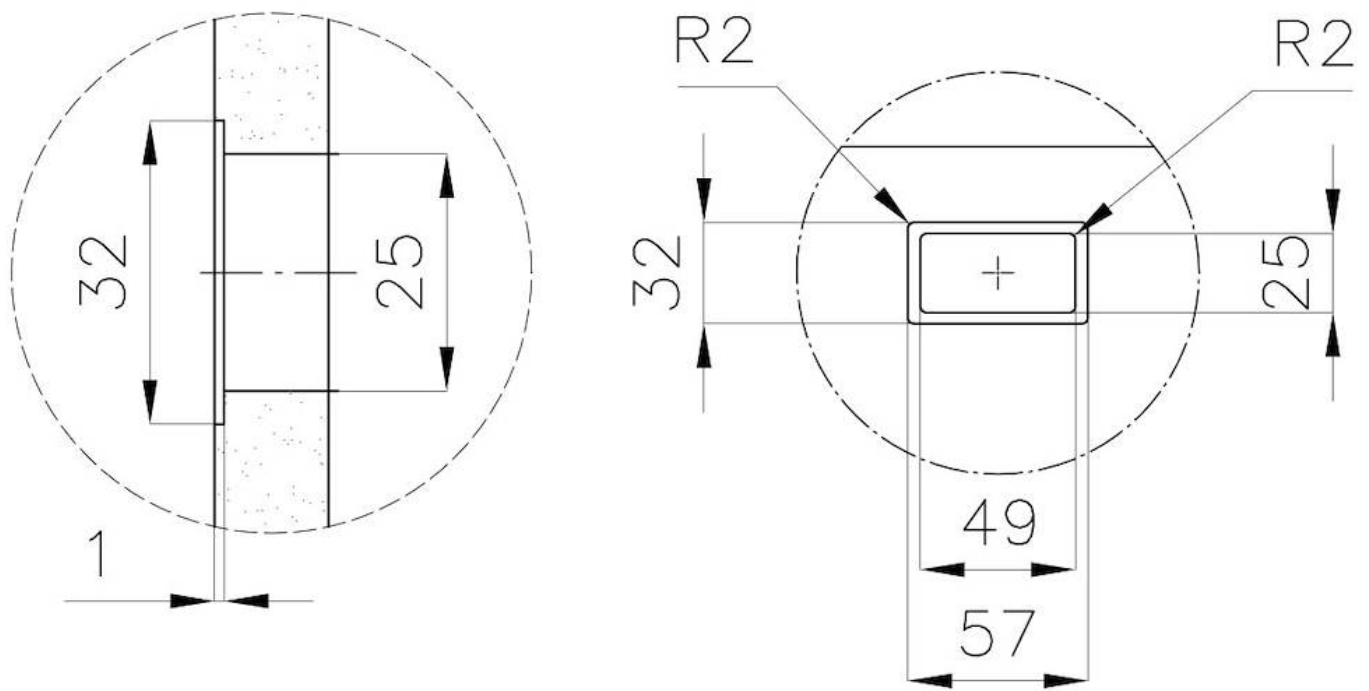

DETTAGLIO PER TROPPO PIENO / OVERFLOW DETAILS

GALLERY



OPTIONAL ACCESSORIES



Black grid
8100 651



Cestello inox
8612 000



HDPE Chopping board
8657 001



Stainless steel plate rack
8100 201



White bowl
8153 100

RECOMMENDED PAIRINGS



Cooker hob Milanello Gun Metal 5F
7682 006



Mixer Tap Omega Plus Gun Metal
8498 856

OPTIONAL AUTOMATIC WASTE FITTINGS



Automatic waste fitting
8407 100



Automatic waste fitting
8407 000



Gun Metal automatic waste fitting - PG
8407 110



Space automatic waste fitting - PA
8407 108



Space Light automatic waste fitting - PL
8407 117



Space Push automatic waste fitting - PP
8407 116